

TGS 8x4 Tipper

Cab Options

'M' Day Cab - Standard

Additional weight: 0 kg

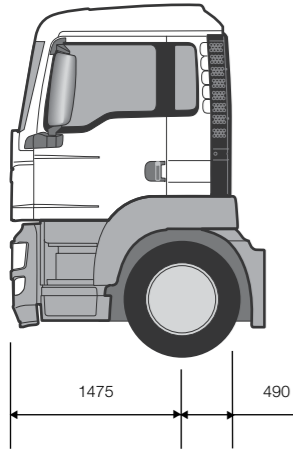

'L' Sleeper

Additional weight: 155 kg

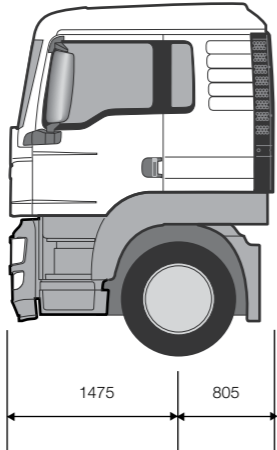

MAN Truck & Bus UK Ltd.,
Frankland Road, Blagrove,
Swindon, Wiltshire SN5 8YU
www.mantruckandbus.co.uk

Ref: MAN TGS 8X4TIP / 09
Issue Date: October 2019
Technical illustrations are not binding. Picture on front cover may not be standard equipment
We reserve the right to make modifications in line with technical progress.

TGS 8x4 Tipper

Chassis Specification: TGS 35.400 8x4 BB
TGS 35.430 8x4 BB
TGS 35.470 8x4 BB



TGS 8x4 Tipper

Base Cab Model TGS 'M' Cab

For cab variants, options and specifications see separate 'TGS Cab Specification' sheet

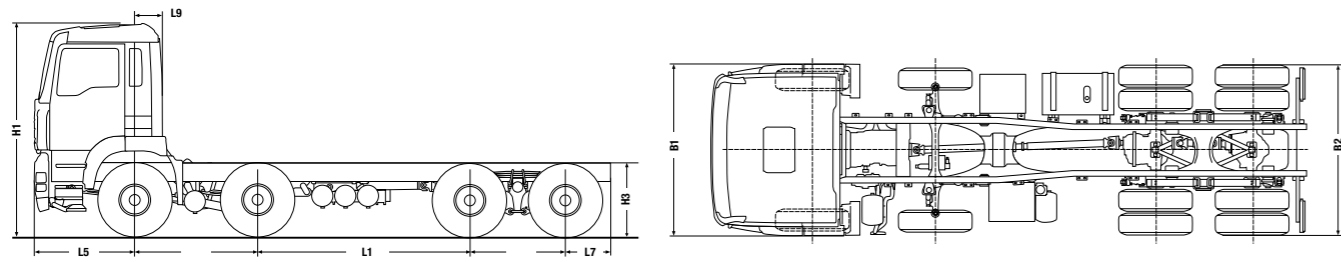

Vehicle Dimensions (mm)

L1	Wheelbase	3205
L2	Rear bogie spread	1400
L5	Front overhang	1475
L7	Rear chassis overhang	800
L9	Centre line front axle to back of cab	490
H1	Ground to top of cab	Laden 3139 Unladen 3223
H3	Ground to top of frame over drive axle	Laden 1032 Unladen 1112
B1	Width across wings	2500
B2	Width across rear tyres	2455

Turning Circle

WTW Wall to Wall	22000
KTK Kerb to Kerb	20300

Unladen Weights (kg +/- 2.5%)

Front axles	6520
Rear axles	3295
Total	9815

N.B. Unladen weights are for vehicle in standard specification with full tank of fuel and AdBlue® but without driver. Weights are subject to a manufacturing tolerance of +/- 2.5%.

Plated/Operating Weights (kg)

	Design	UK Legal
GVW Gross Vehicle Weight	35000	32000
Front axles	14200 ⁽¹⁾	14200 ⁽¹⁾
Drive axles	23000	19000

N.B. Tyre changes can effect legal weights. ⁽¹⁾ Alternative Front Axle capacity available: 15000 kg; 16000 kg.

Optional Equipment & Weights (kg)

	Front	Rear	Total		Front	Rear	Total
D1556 engine in lieu of D2676 engine	-195	0	-195	L Sleeper cab	+155	0	+155
9.00 x 22.5 Alcoa alloy wheels	-76	-152	-228	225 Ah Batteries	+30	0	+30
Manual gearbox	+55	+10	+65	Hub Reduction Rear Axles	0	+280	+280
Air conditioning	+40	0	+40				

All weights indicated above are subject to +/- 2.5% manufacturer's tolerance.

TGS 8x4 Tipper



Engine Model - Euro 6

	D1556LF07	D2676LF80	D2676LF79
Engine Power (PS)	400	430	470
Rated Speed (rpm)	1800	1800	1800
Torque (Nm)	1800	2200	2400
Torque Range (rpm)	1000 - 1500	930 - 1350	930 - 1350
Cylinders	6	6	6
Capacity (cc)	9037	12419	12419

Features

- Common Rail EDC
- Cruise Control
- Exhaust valve brake
- Road speed limiter set to 89 kph
- OBD-D

Performance @32000 kg

Engine Power	Gearbox	Axle Ratio	Geared Road Speed (mph)	Engine RPM		Starting Grade	Tyre Size
				@55 mph	@50 mph		
400PS	1228 OD	3.7:1	79	1290	1180	33%+	295/80R22.5
430PS	1228 OD	3.7:1	79	1290	1180	33%+	295/80R22.5
470PS	1228 OD	3.7:1	79	1290	1180	33%+	295/80R22.5

Clutch

Single plate 430mm diameter, asbestos free lining

Axles

Steer VO-09 straight beam
Drive HYD-1160/HY-1133 hypoid axle complete with cross axle and inter axle diff locks

Braking System

Type Electronic Brake System (EBS) with Anti-lock Braking System (ABS)
Features Vented Disc Brakes on steer axles, Drum Brakes on drive axles
Parking Brake Spring brakes on rear axle

Gearbox

MAN TipMatic® 12 speed automated gearbox

Ratios

1	12.92	2	9.98
3	7.67	4	5.94
5	4.57	6	3.53
7	2.83	8	2.19
9	1.68	10	1.30
11	1.00	12	0.77
R1	12.03	R2	9.29

Suspension

Steer Axle Parabolic Springs with Shock Absorbers and Stabiliser
Rear Bogie Inverted two spring Parabolic Springs Hydraulic Dampers Stabiliser on rear axles

Steering Gear

Type ZF Servocom hydraulically assisted with auxiliary ram

Wheels & Tyres

Steer Axle	Tyres	295/80R 22.5 on/off road tread
	Wheels	9.00x22.5
Drive Axle	Tyres	295/80R 22.5 on/off road tread
	Wheels	9.00x22.5

Frame

Construction Bolted and Riveted
Material High tensile steel (S500MC)
Section 270 x 85 x 8mm
942 - 762mm waisted

Exhaust System

Ground discharge silencer, incorporating diesel particulate filter (DPF)

Electrical System

Type MANTronic CAN bus system with central on board computer and vehicle management computer

General Equipment

35 litre AdBlue® tank
Electronic immobiliser
Mechanical battery master switch
Heated fuel filter
PTO NH/4c
Water trap
N3G certification

Fuel Tank

Capacity 300 Litre
Section Rectangular Steel
RHS mounted
Locking cap

Voltage 24v
Alternator 80 Amp
Batteries 2 x 12v 175Ah